

# SOLENOID VALVES

COILS & CONNECTORS



## Dimensional Data

Units: mm/ (Inch)

### C-Voltage/ Current Type Mini-DIN Coil

C-12VDC C-24VDC C-24VAC  
C-110VAC C-220VAC



C-110VAC

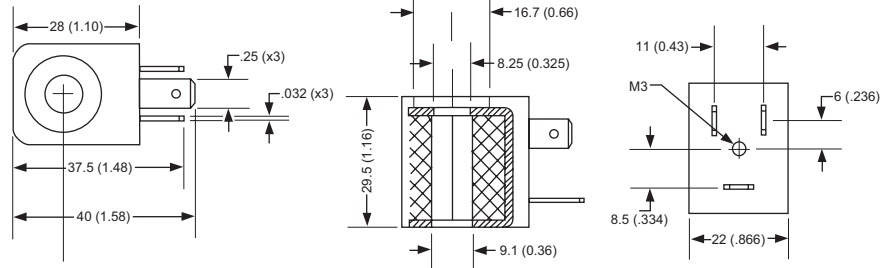

### CC-SR Strain Relief Connector

CC-SRL-DC (6-48VAC or VDC)  
CC-SRL-AC (100-240 VAC)



CC-SRL-AC

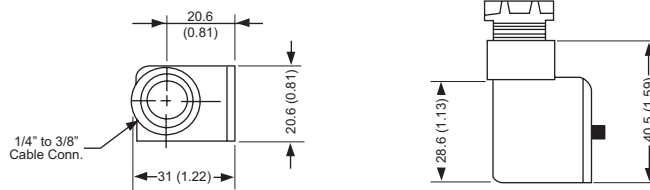

### CC-CD 1/2" Conduit Connector

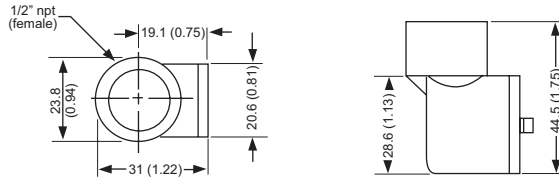

### CC-LW 36" Lead Wire Connector

CC-LWL-DC (6-48VAC or VDC)  
CC-LWL-AC (100-240VAC)

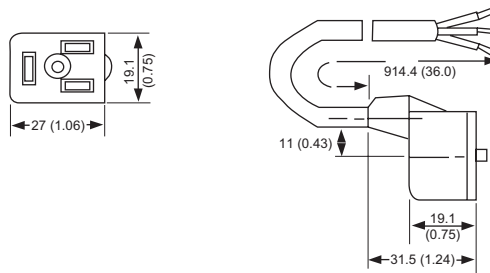

## Ordering Information

### 110A - SRL

Coil Voltage	Code	Electrical Connector
12D (DC)	SR	Strain Relief
24A (AC)	CD	1/2" Conduit
24D (DC)	LW	Lead Wire 36"
110A (AC)	SRL	Strain Relief-Lighted (standard)
220A (AC)	CDL	1/2" Conduit-Lighted
	LWL	Lead Wire 36"-Lighted

