

# PISTON PUMPS

SERIES PCP33



ISO C, 4-Bolt

## Specifications

**PCP33** 1800 RPM, 33.2 GPM (at no load), 3000 PSI Max

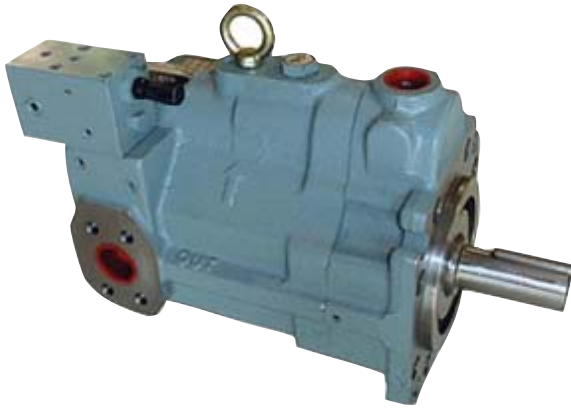

Series PCP33 Piston Pumps

Model	Pressure Range (psi)	Displacement per rev.	Flow @ 1800 RPM	Weight
PCP33-.5K-4CK-2	143-500	4.27 cu-in	33.2 gpm (125.7 lpm)	81.7 lbs 37.0 kgs
PCP33-1K-4CK-2	286-1000			
PCP33-2K-4CK-2	500-2000	70.0 cc		
PCP33-3K-4CK-2	500-3000			

## Performance Data

Typical performance curves based on ISO VG32 Oil @120°F, (49°C)

### Efficiency Curves

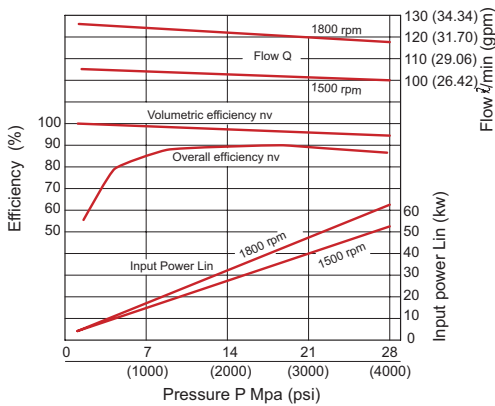

### Pressure vs Flow

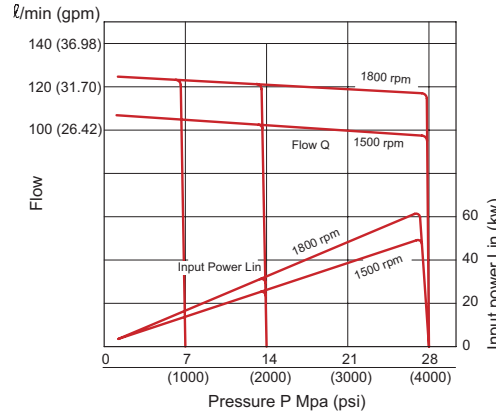

### Power Input

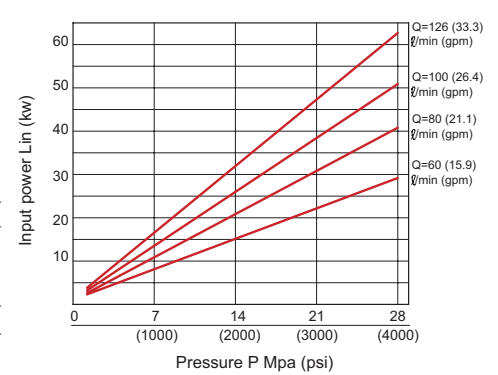

### Deadhead Power

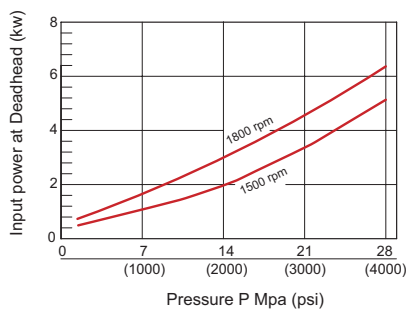

### Noise Level

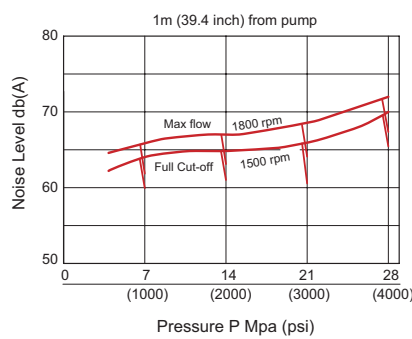

### Drain Curve

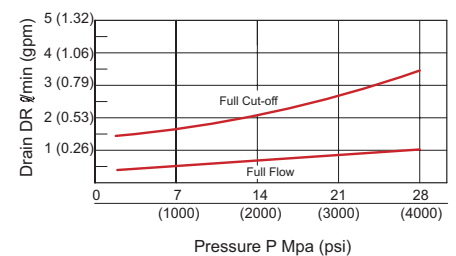

# PISTON PUMPS

SERIES PCP33



ISO C, 4-Bolt

## Dimensional Data

### PCP33-3K-4CK-2

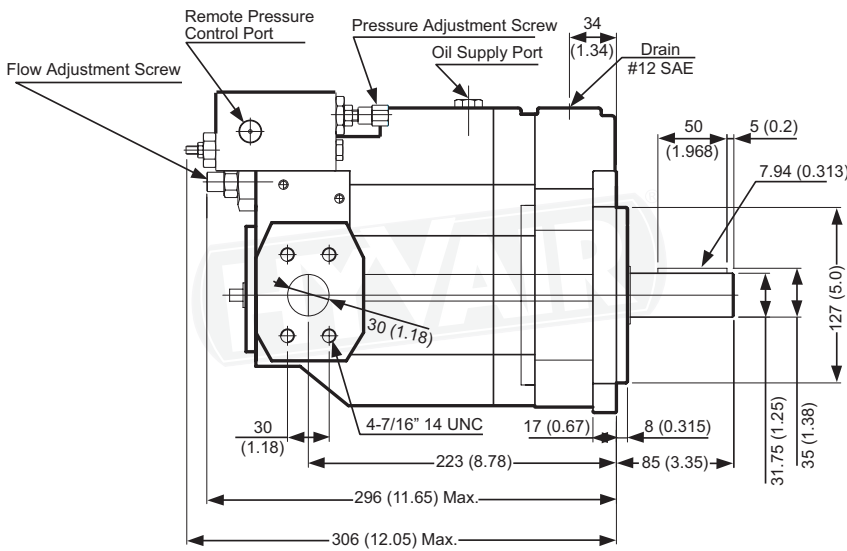

Units: mm (Inch)  
Weight: 81.7 lbs/ 37.0 kgs

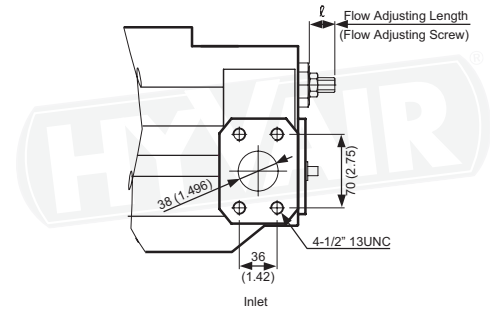
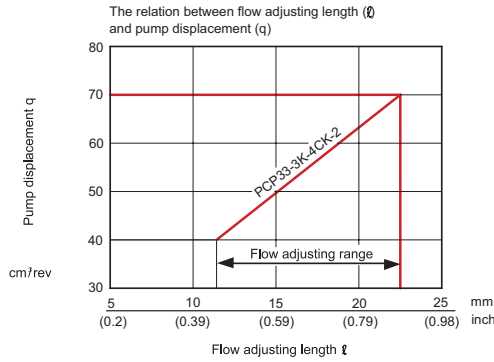
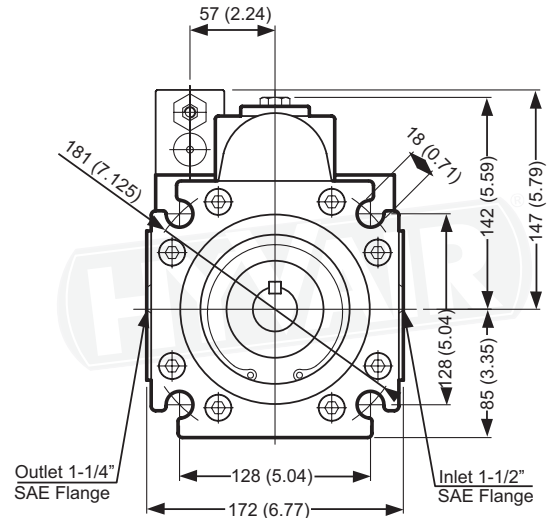

### PCP33-3K-4CK-4CS-2

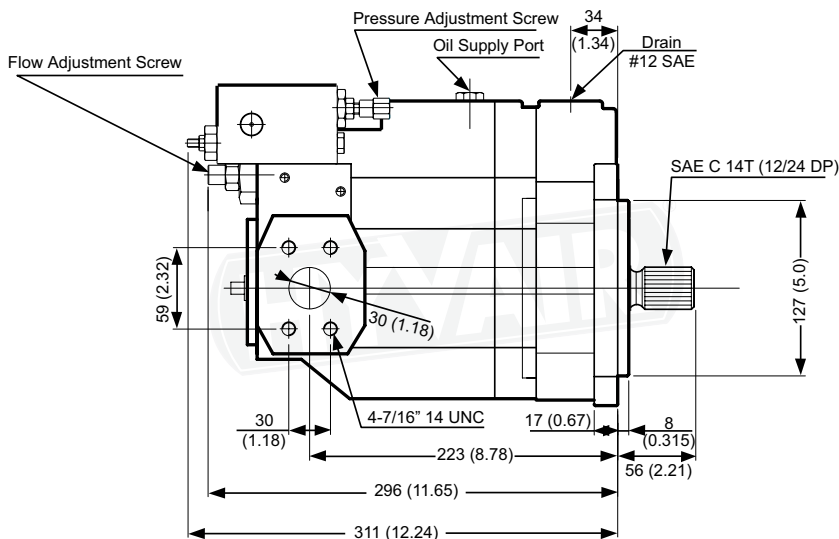

Units: mm (Inch)  
Weight: 81.7 lbs/ 37.0 kgs

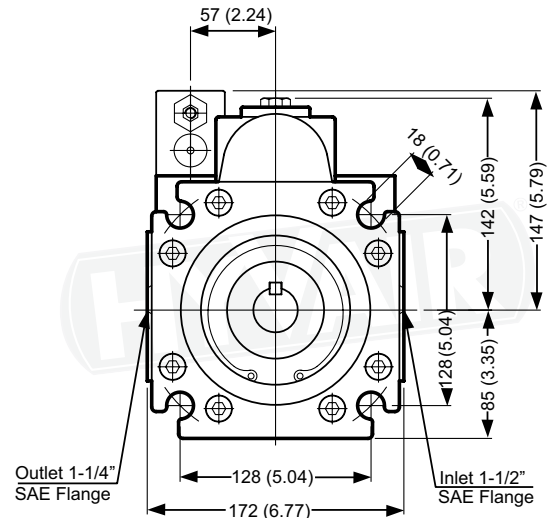

# PISTON PUMPS

SERIES PCP33



ISO C, 4-Bolt

## Dimensional Data

### PCP33-3K-4CK-2-LS

Units: mm (Inch)  
Weight: 83.5 lbs/ 37.9 kgs

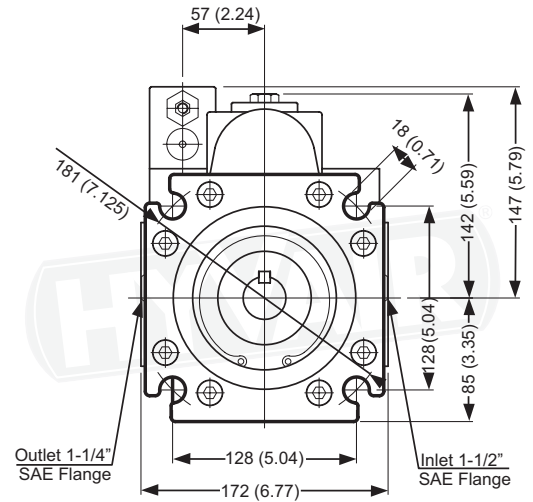
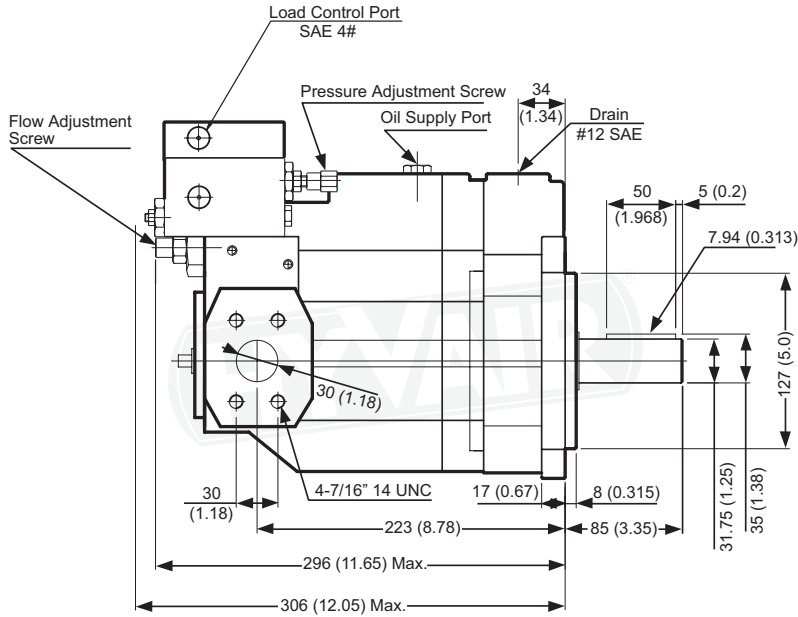

### PCP33-3K-4CK-2-2PSO

Units: mm (Inch)  
Weight: 96.3 lbs/ 43.7 kgs

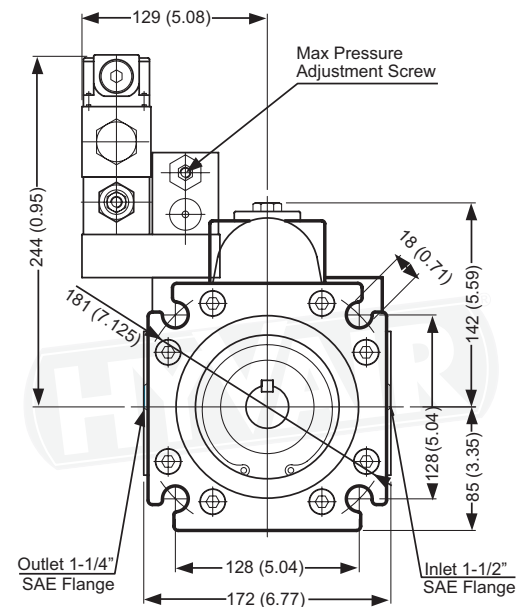
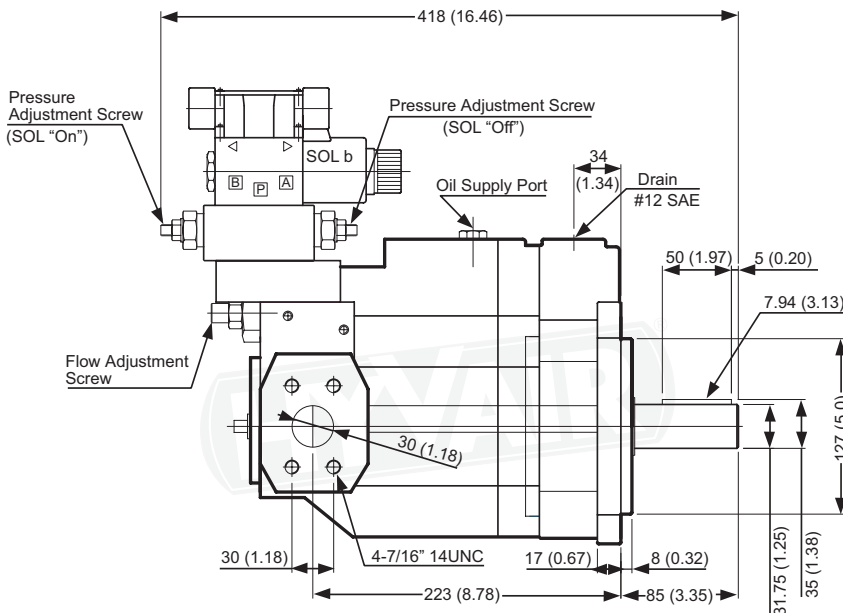

# PISTON PUMPS

SERIES PCP33



ISO C, 4-Bolt

## Dimensional Data

**PCP33-3K-4CK-2-SO**

Units: mm (Inch)  
Weight: 92.95 lbs/ 42.2 kgs

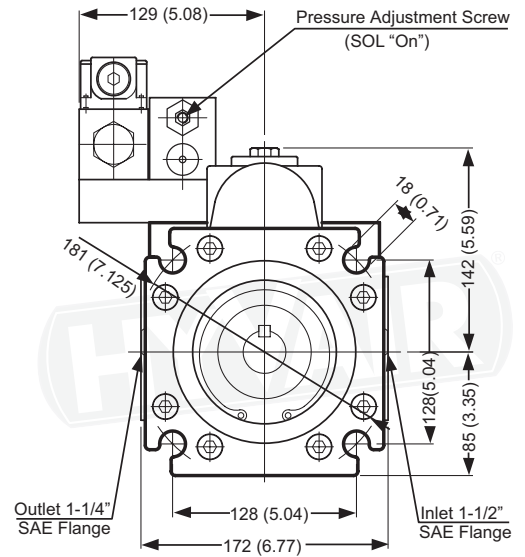
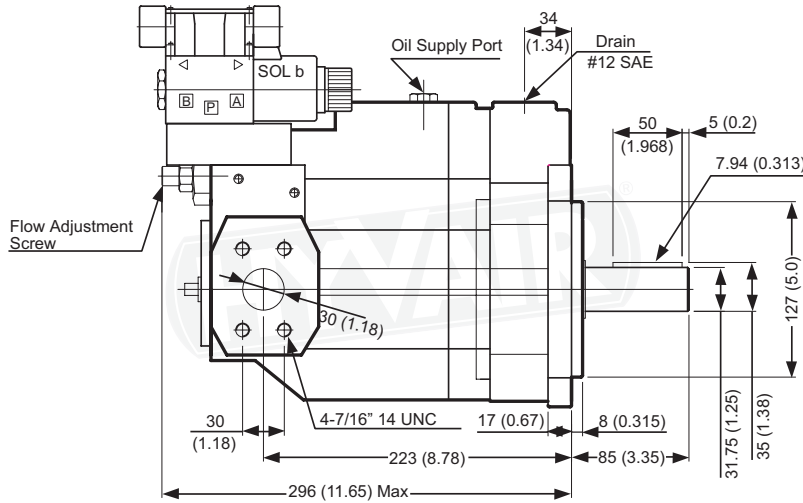

## Ordering Information

**PCP33 - 3K - 4CK - 2 - 2PSO**

Note: Available right hand rotation (only)- viewed facing pump shaft

Size (GPM)
33

Code	Pressure Range
.5K	143-500 PSI
1K	286-1000 PSI
2K	500-2000 PSI
3K	500-3000 PSI

Code	Mounting Style
4CK	4-Bolt ISO C, 1 1/4" Dia. Keyed Shaft x 3" Long w/ 5/16" Key, w/ Flow Adj.
4CS	4-Bolt ISO C, 14 Tooth Spline, 12/24 DP

Series 2 Porting
Inlet- 1 1/2" SAE Flange Outlet- 1 1/4" SAE Flange Case Drain- #12 Female SAE

Code	Control Type
omit	Standard
LS	Load Sensing
2PSO	Dual Pressure Solenoid
SO	Single Pressure Solenoid

